

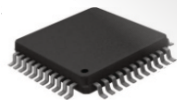

GEST130 MEGA-RING Blue Line

130 mm Direct light illuminator

Internal Controller with
4 driving modes



Led Status	Internal controller with 4 driving modes	
1	100%	Continuous use
2	200%	Semi-continuous use
3	400%	Strobe use
4	10-100%	Analog Reg

M12 5P Male Connector	
Pin 1	+24V
Pin 2	Start NPN < 1 to 0V
Pin 3	GND
Pin 4	Start PNP > 3 to 24V
Pin 5	1-10V Analog Reg.

Develop your custom solution

18 Standard Colours

Base IP65 Protection Degree

Variant IP67 Protection Degree

24 Vdc

Optional Polarizing Filter

CE RoHS

UK CA

FC

Illuminator Features :

- Project achieved by internal resources and Genesi skills;
- Fast controller which allows to have the following modes: PNP, NPN, Analog Regulation, Strobe and Semi-Continuous Use;
- Microcontroller to monitor the pulse duration and the maximum temperature;
- Model with Huge Lenses; 10°, 30°, 60° or 90° transparent, satin and opaline covers;
- Powerful and Fast strobe mode with energy buffering and strobe duration control, Min. pulse from 3 µs;

COLOUR	WHITE		UV-A				VISIBLE				NIR			SWIR				
	White 6000K -6K	White 4000K -4K	UV 365nm -365	UV 385nm -385	UV 395nm -395	UV 405nm -405	Blue 450nm -450	Green 524nm -524	Red 625nm -625	Deep Red 660nm -660	IR 730nm -730	IR 850nm -850	IR 950nm -950	SWIR 1050nm -1050	SWIR 1200nm -1200	SWIR 1300nm -1300	SWIR 1450nm -1450	SWIR 1550nm -1550
Continuous use power	15W		10W				15W				12W	15W		10W				
Semi-continuous use power	30W		18W				30W				25W	30W		15W				
Strobe use power	75W		30W				75W				60W	75W		25W				

GEST130 Part Number

Ex. Code : **GEST130** -YYY -WW1 -WW2

-YYY	Led Colour		EN 62471	
-6K	Base 6000K Cold White	White	RISK1	-L10
-4K	4000K Natural White			RISK2
-365	UV 365 nm	UV - A	RISK3	
-385	UV 385 nm			
-395	UV 395 nm			
-405	UV 405 nm			
-450	450 nm Royal Blue			
-524	524 nm Green	Visible	RISK1	
-625	625 nm Red			
-660	660 nm Deep Red			
-730	730 nm IR	Nir	RISK2	
-850	850 nm IR			
-950	950 nm IR			
-1050	1050 nm SWIR	Swir	RISK2	
-1200	1200 nm SWIR			
-1300	1300 nm SWIR			
-1450	1450 nm SWIR			
-1550	1550 nm SWIR			
-YYY	Colour on demand			

-WW1	Cover variants
-T	Base Trasparent cover (90°)
-OP	Opaline cover
-L10	10° Lens + Transparent Cover
-L30	30° Lens + Transparent Cover
-L60	60° Lens + Transparent Cover
-45T	45° Lens + Transparent Cover only UV-A

-WW1	IP
	Base IP 65
IP 67	IP 67 Additional protection 8 mm Transparent Plexiglass + gaskets + screws
IP 67F	Additional FULL protection IP67 8 mm transparent plexiglass + gaskets + screws

-WW2	Cables
	20 cm cable + M12 5P M
-WW2	Supply connection on demand

Optional wavelenghts and lens available on request

Part Number Examples:

GEST130-6K-L30

Mega-Ring light 4 Driving Modes 130 mm diameter White 6000K 30° Lens transparent cover 2200/11200Lm 0,62/3,15A 15/75W 20cm cable M12 M 5P

GEST130-625-T

Mega-Ring light 4 Driving Modes 130 mm diameter RED 625nm transparent cover 0,62/3,15A 15/75W 20cm cable M12 M 5P

GEST130-365-45T

Mega-Ring light 4 Driving Modes 130 mm UV 365nm 45° Lens transparent cover 0,4/1,25A 10/30W 20cm cable M12 M 5P

OPERATING MODE

100% CONTINUOUS USE

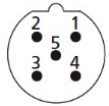
Connector	PINS	Function	Description
	1	+24 V	A) START NPN → PIN2: 0 to 1 V; B) START PNP → PIN4: 3 to 24 V; For the continuous use: it is possible to connect PIN4 directly to +24 V or PIN2 to GND
	2	A) Start NPN: 0-1 V	
	3	GND	
	4	B) Start PNP: 3-24 V	
	5	-	

200 % SEMI-CONTINUOUS USE

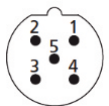
Connector	PINS	Function	Description
	1	+24 V	Precondition: PIN5: 24 V A) START NPN → PIN2: 0 to 1 V; B) START PNP → PIN4: 3 to 24 V; In this mode → Ton_{max} = 60 s - Dt_{max} = 50% For the semi-continuous use: it is possible to connect PIN4 directly to +24 V or PIN2 to GND. To use it in continuous mode with DT _{max} from 51% to 100%: it is necessary to use the heat sink or forced ventilation.
	2	A) Start NPN: 0-1 V	
	3	GND	
	4	B) Start PNP: 3-24 V	
	5	+24 V	



400% STROBE USE

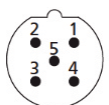

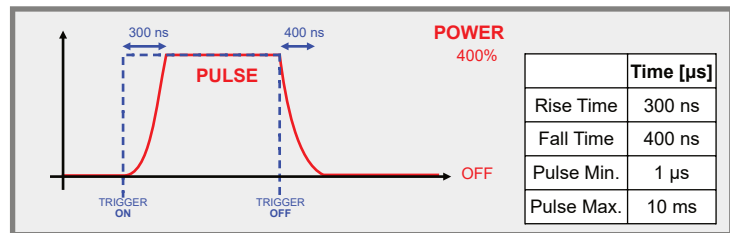
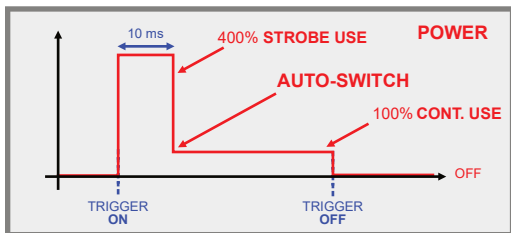
Connector	PINS	Function	Description
	1	+24 V	A) START NPN → PIN2: 0 to 1 V; B) START PNP → PIN4: 3 to 24 V; In this mode → Ton_{max} = 10 ms - Dt_{max} = 10% AUTO-SWITCH in continuous use.
	2	A) Start NPN: 0-1 V	
	3	GND	
	4	B) Start PNP: 3-24 V	
	5	-	



ANALOG REGULATION USE 100%

Connector	PINS	Function	Description
	1	+24 V	PIN5 from 1 to 10 V can adjust the power from 10% to 100%. 
	2	-	
	3	GND	
	4	-	
	5	1 V - 10 V	



400% STROBE USE POWER can be reached only from WHITE / VISIBLE / NIR LEDS, for other wavelenghts check the power table at page 1.



MicroController temperature protection → at 80°C the PCB enables the protection and restores the functioning at T < 60°C.

MECHANICAL DRAWING

Scale	Unit of measurement
1:3	mm
Weight	
440 g	

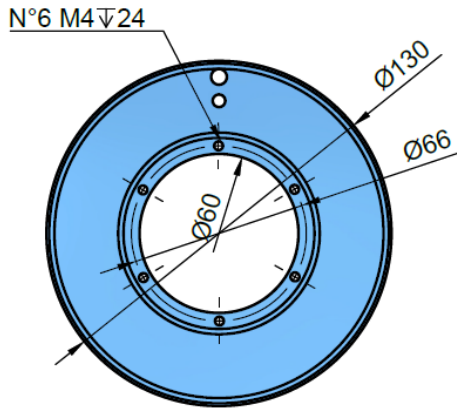
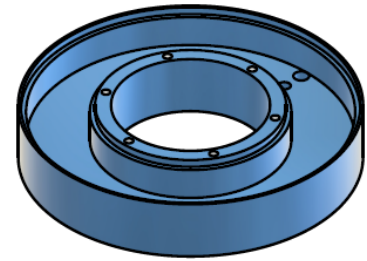

For 3D mechanical drawing requests - info@genesi-lux.it

LIGHT PROJECTION

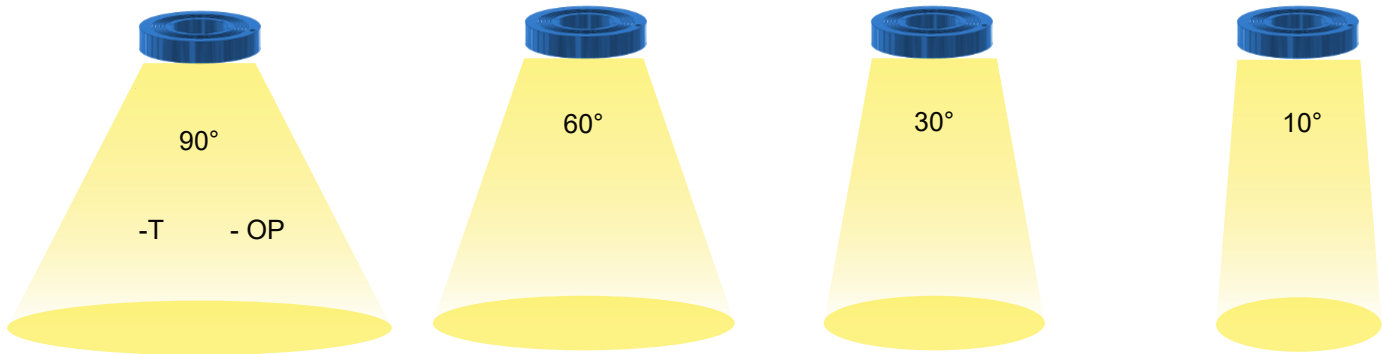

-T		
Working distance	Power W/m ²	Uniform area diameter
8 cm	68 - 126 - 270	18 cm
20 cm	31 - 58 - 124	20 cm
50 cm	8 - 14 - 30	35 cm

-L60		
Working distance	Power W/m ²	Uniform area diameter
15 cm	80 - 149 - 320	20 cm
50 cm	28 - 51 - 110	26 cm
100 cm	8 - 14 - 32	56 cm

-L30		
Working distance	Power W/m ²	Uniform area diameter
30 cm	75 - 140 - 300	18 cm
50 cm	50 - 95 - 200	22 cm
100 cm	20 - 36 - 80	28 cm

-L10		
Working distance	Power W/m ²	Uniform area diameter
40 cm	77 - 145 - 308	20 cm
100 cm	32 - 59 - 126	24 cm
200 cm	9 - 17 - 36	32 cm

-OP		
Working distance	Power W/m ²	Uniform area diameter
8 cm	31 - 58 - 124	18 cm
20 cm	13 - 24 - 50	22 cm
50 cm	3 - 6 - 12	35 cm

CONTINUOUS USE SEMI-CONTINUOUS USE STROBE USE

Powers related to the white colour with homogeneity ± 10%



Genesi LUX®

GENESI ELETTRONICA SRL - VIA BACHELET, 3/A - 41057 SPILAMBERTO (MO) - ITALY
info@genesi-lux.it - TEL. +39 059785566 - www.genesi-elettronica.com
 ©All Rights Reserved GENESI ELETTRONICA - GEST130 MEGA-RING



Organization with a certified ISO 9001:2015 Quality Management System

Rev. 01/26

ACCESSORIES

CODE	DESCRIPTION
GEST130-PX2-AP	Additional Protection 2 mm Transparent Plexiglass + screws
GEST130-PX2-UV-AP	Additional Protection 2 mm UV permeable Transparent Plexiglass + screws
GEST130-ST2-AP	Additional Protection 2 mm Satin Plexiglass + screws
GEST130-OP2-AP	Additional Protection 2 mm Opaline Plexiglass + screws
GEST130-PC2-AP	Additional Protection 2 mm Transparent Polycarbonate + screws
GEST130-P-AP	Additional Protection 2 mm Transparent Plexiglass + Polarizing Filter + screws (ONLY STROBE USE)
GEST130-PX2-APF	Additional FULL Protection for Camera and illuminator 2 mm Transparent Plexiglass + screws
GEST130-PX8-AP	Additional protection IP67 8 mm transparent plexiglass + gaskets + screws
GEST130-PX8-APF	Additional FULL protection IP67 8 mm transparent plexiglass + gaskets + screws
GE-M12F-5X050-2M	M12 connector female cable 2 meters long
GE-M12F-5X050-5M	M12 connector female cable 5 meters long
GE-M12F-5X050-10M	M12 connector female cable 10 meters long
GE-ABS606E	LED Voltage Control with 6 programmable channels and 10/100 Ethernet. Second level controller for Camera and illuminator.

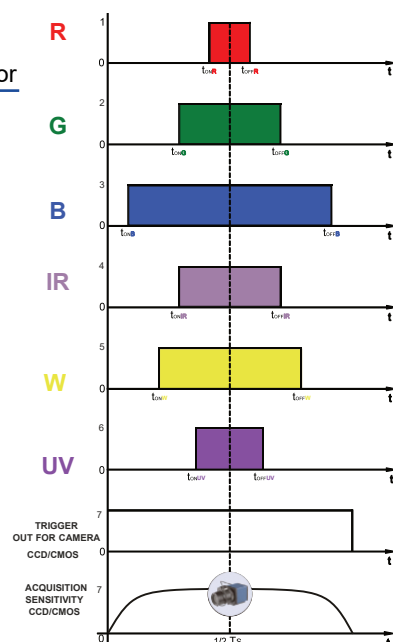
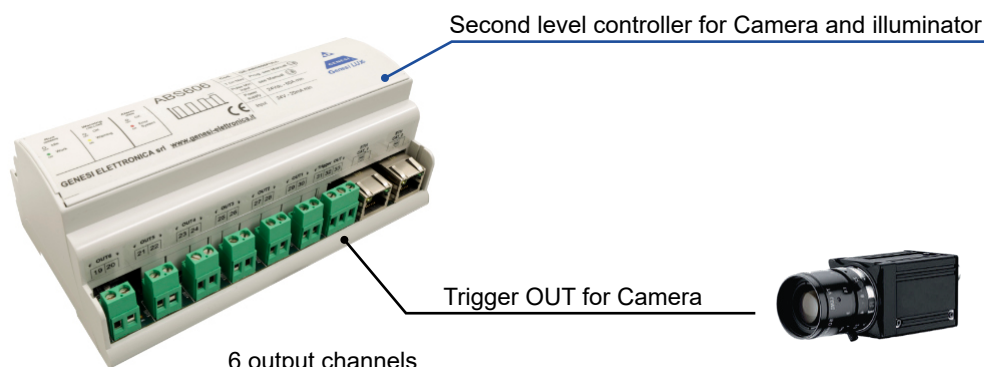
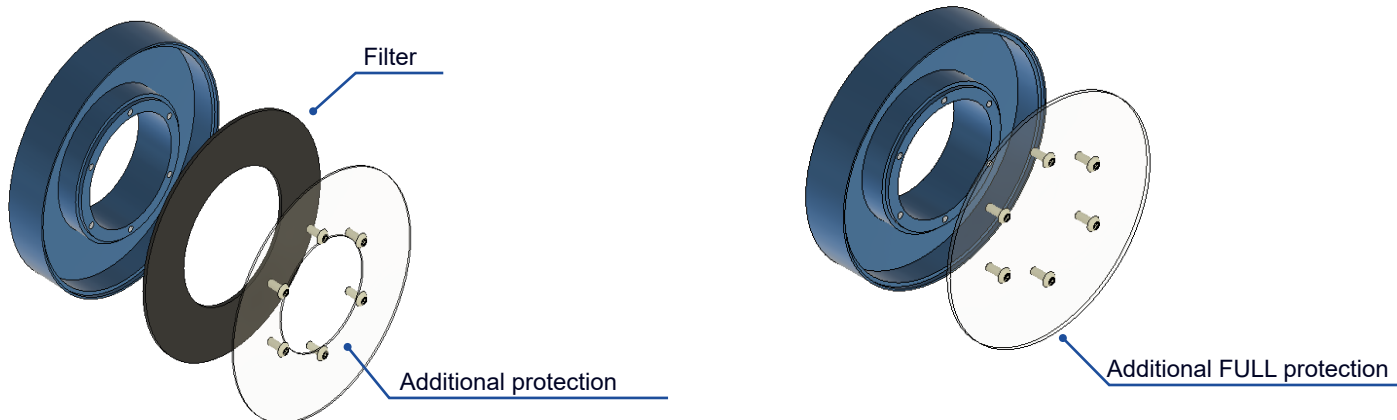

SPECIAL VERSION

PHOTOMETRIC STEREO

CODE: GEST130-YYY-WW1-PHS

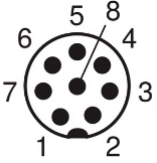
Connector	PINS	Function	Description
	1	OUT error (+24 V)	Illuminator with 2 sectors that can be driven independently. 100% continuous use, 200% semi continuous use, or 400% strobe for every sector.
	2	+24 V	
	3	A) Start PNP: 15-24 V	
	4	B) Start PNP: 15-24 V	
	5	NC	
	6	NC	
	7	GND	
	8	Set +24 V to semi continuous mode (200%)	



Tailor-Made

Connector	PINS	Function	Description
M12 Male	1		
	2		
	3		
	4		
	5		

DEVELOP YOUR CUSTOM PRODUCT WITH OUR R&D TEAM

LED STATUS

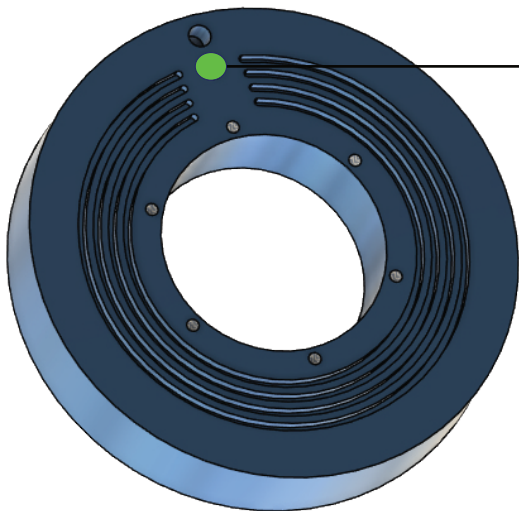

Mode	Led colour signal	Function/note
Powered	Blue	-
100% Continuous use	Green	-
0-100% Analog Reg	Yellow	-
400% Strobe Use	Fast blinking green	-
200% Semi-continuous use standby	Purple	Without PNP or NPN input only +24V analog IN
200% Semi-continuous use	Slow blinking purple	With PNP or NPN input +24V analog IN
Over 10% ton error	Fast blinking red	10 sec stop
Over 80° temperature in pcb controller	Slow blinking green-yellow-red	Up to < 60° stop

The indicated IP protection degree is guaranteed only if the product is positioned downward

Base
IP65
Protection Degree

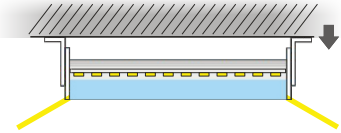

NEW SOLUTION

DESIGN A NEW ONE

info@genesi-lux.it



SAMPLE

TEST THE PRODUCT

info@genesi-lux.it



DOWNLOAD

TECHNICAL SPECIFICATIONS

www.genesi-elettronica.com



REQUEST

THE PRICE LIST

info@genesi-lux.it

STANDARDS		
EMC immunity :	EN 61547:2009	
EMC emission :	EN 55015:2019	
Photobiologic risk :	EN 62471:2008 GLS:	
Assessment of lighting equipment related to human exposure to electromagnetic fields	EN 62493:2015	

WARNING

-Electrical device exclusively for professional use. Installation can be done by qualified personnel only.

-In case of power supply wire damage, its replacement has to be done at the head office exclusively.

Warranty loss in case of inappropriate use and tampering.



Design & Production
Made in Italy



Genesi LUX®

GENESI ELETTRONICA SRL - VIA BACHELET, 3/A - 41057 SPILAMBERTO (MO) - ITALY

info@genesi-lux.it - TEL. +39 059785566 - www.genesi-elettronica.com

©All Rights Reserved GENESI ELETTRONICA - GEST130 MEGA-RING



Organization with a
certified ISO 9001:2015
Quality Management System

Rev. 01/26